

**This electronic collection of documents is provided  
for the convenience of the user  
and is Not a Certified Document –**

**The documents contained herein were originally issued  
and sealed by the individuals whose names and license  
numbers appear on each page, on the dates appearing  
with their signature on that page.**

**This file or an individual page  
shall not be considered a certified document.**

STATE OF NORTH CAROLINA  
 DIVISION OF HIGHWAYS

PROJ. REFERENCE NO.	SHEET NO.
17BP.14.R.183	X-1A

Approximate quantities only. Fine grading, clearing and grubbing, and removal of existing pavement will be paid for at the lump sum price for "Grading".

NOTE: EMBANKMENT COLUMN DOES NOT INCLUDE BACKFILL FOR UNDERCUT

CROSS-SECTION SUMMARY

Station	Uncl. Exc. (cu. yd.)	Embt (cu. yd.)																			
L																					
11+00.00	0	0																			
11+50.00	187	7																			
12+00.00	269	22																			
12+50.00	136	33																			
12+76.00	48	12																			
Station	Uncl. Exc. (cu. yd.)	Embt (cu. yd.)																			
L																					
14+02.86	0	0																			
14+25.17	3	145																			
14+50.00	8	115																			
15+00.00	360	49																			
15+50.00	527	8																			
15+80.00	105	1																			
Station	Uncl. Exc. (cu. yd.)	Embt (cu. yd.)																			
DW1																					
10+10.00	0	0																			
10+50.00	567	0																			
11+00.00	719	0																			
11+47.00	180	0																			
Station	Uncl. Exc. (cu. yd.)	Embt (cu. yd.)																			
DW2																					
10+10.00	0	0																			
10+50.00	0	111																			
10+95.00	0	50																			

INDEX OF SHEETS	
-L-	X-1 THRU X-10
-DW1-	X-11 THRU X-13
-DW2-	X-14 THRU X-15

6/23/16

**RS&H** NC FIRM LICENSE No: F-0493

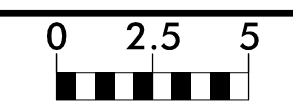

PROJ. REFERENCE NO.	SHEET NO.
17BP.14.R.183	X-1

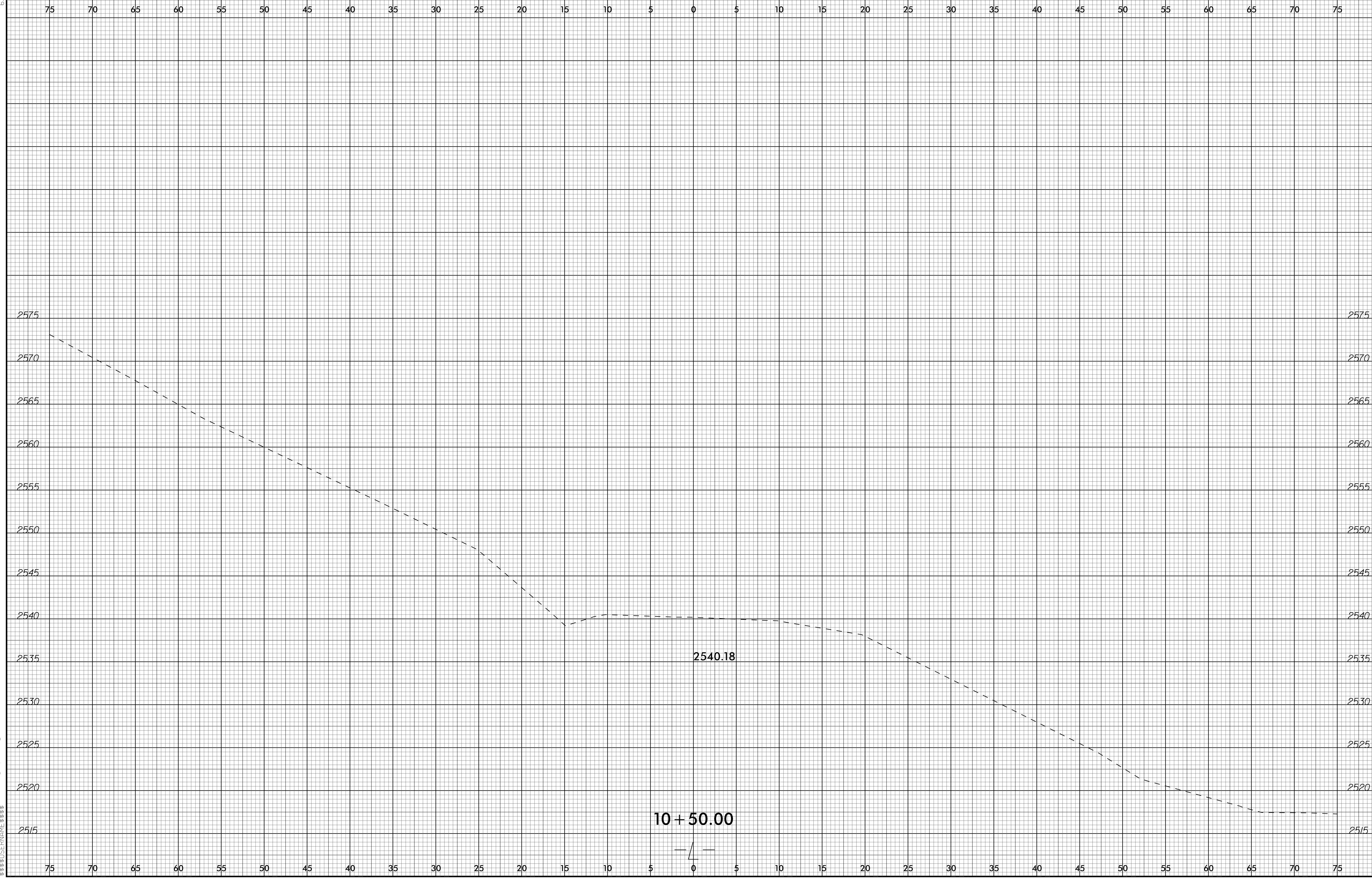

2540.18

10 + 50.00

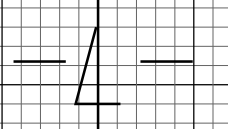

15-MAR-2021 09:36  
 S:\PROJECTS\17BP.14.R.183\17BP.14.R.183.dgn  
 17BP.14.R.183

6/23/16

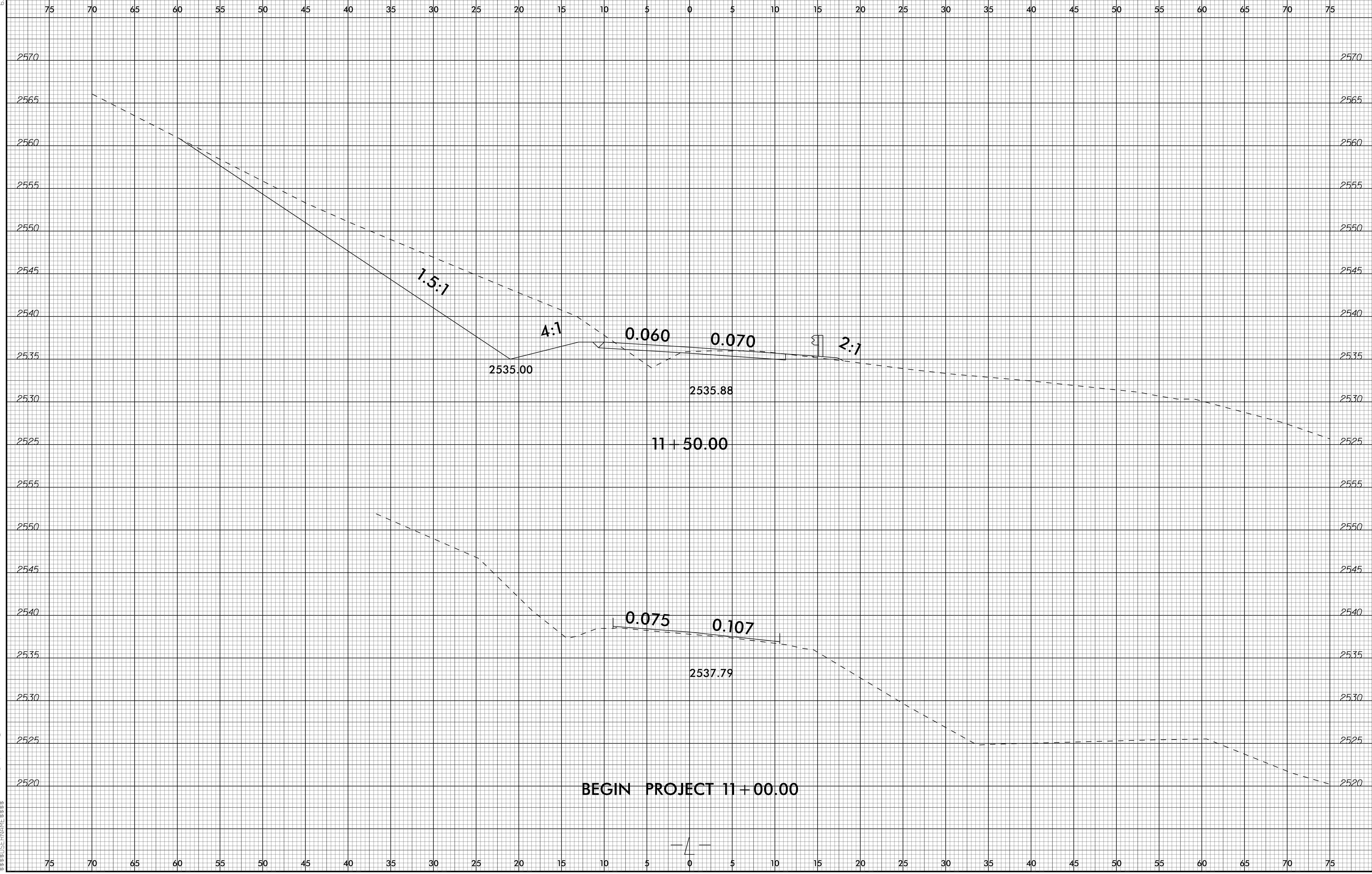
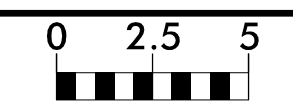

15-MAR-2021 09:37  
S:\PROJECTS\17BP.14.R.183\17BP.14.R.183.dgn

6/23/16

**RS&H** NC FIRM LICENSE No: F-0493

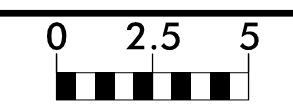

PROJ. REFERENCE NO.  
17BP.14.R.183

SHEET NO.  
X-3

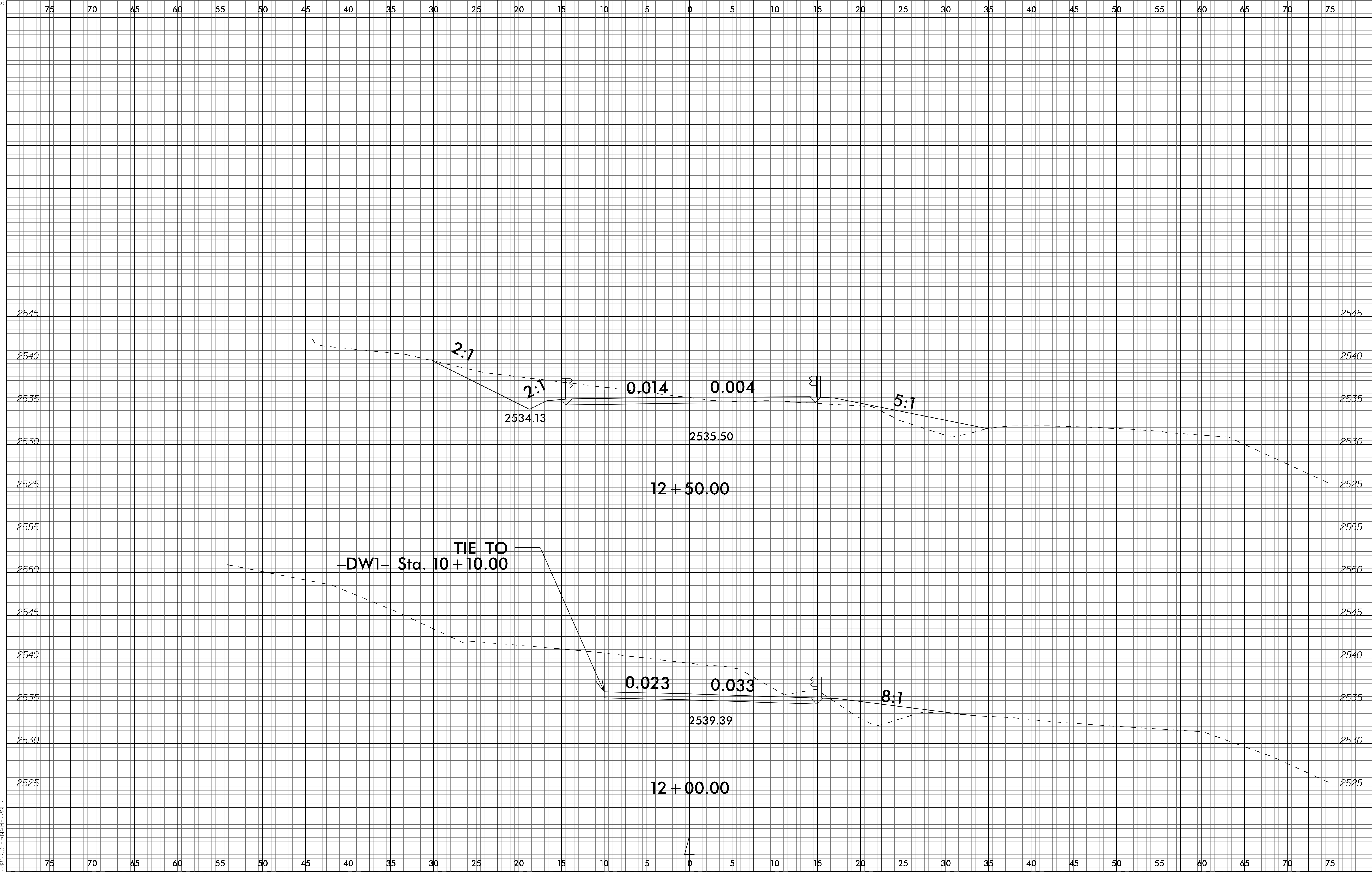

15-MAR-2021 09:37  
S:\PROJECTS\17BP.14.R.183\DWG\17BP.14.R.183-X-3.dgn

6/23/16

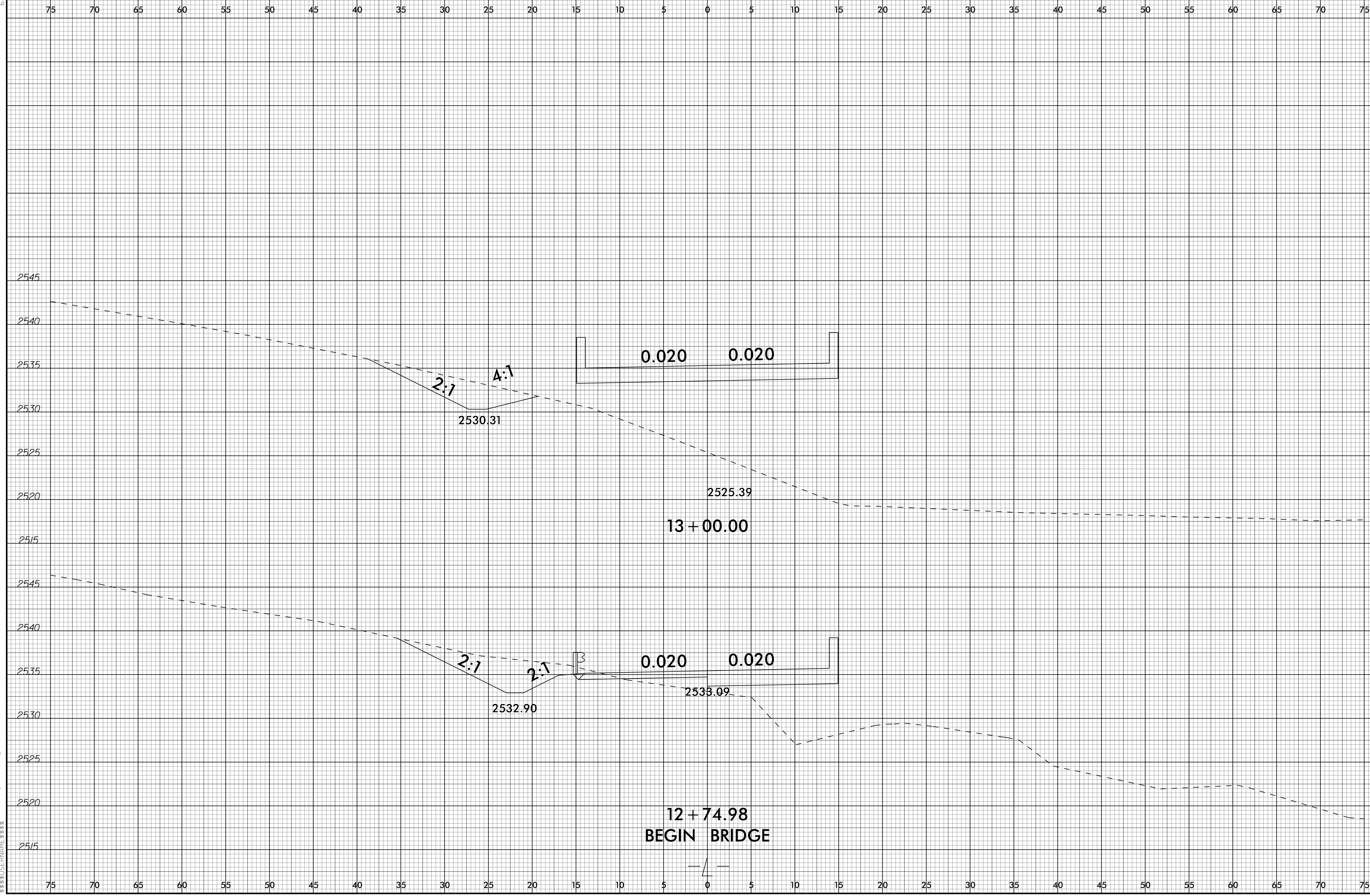
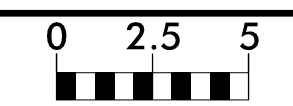

15-MAR-2021 09:38  
S:\PROJECTS\17BP.14.R.183\17BP.14.R.183.dgn

6/23/16

**RS&H** NC FIRM LICENSE No: F-0493

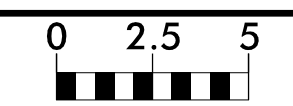

PROJ. REFERENCE NO.  
17BP.14.R.183

SHEET NO.  
X-5

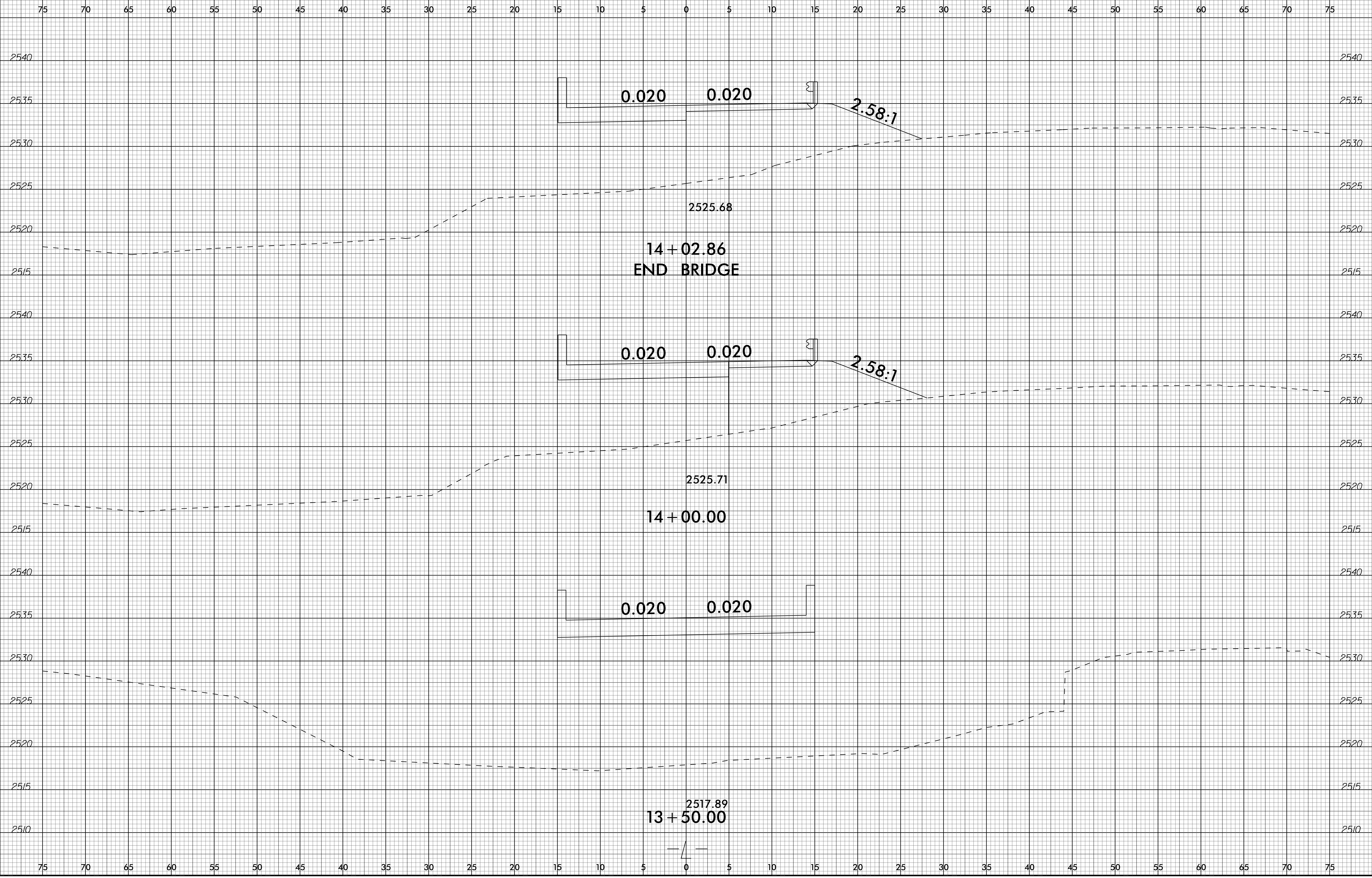

15-MAR-2021 09:38  
S:\PROJECTS\17BP.14.R.183\X-5.dgn

6/23/16

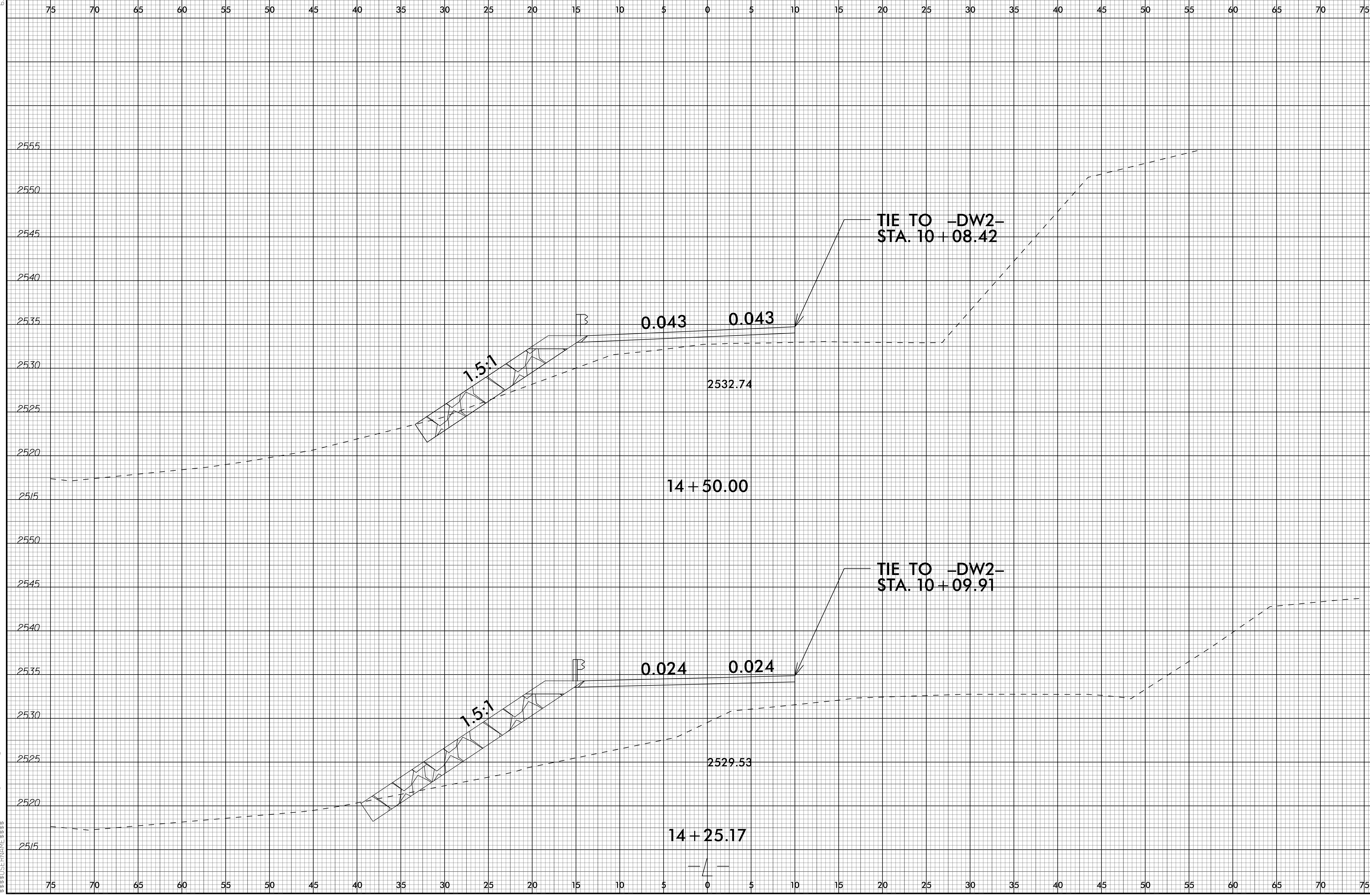
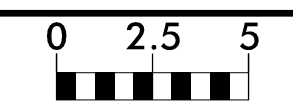

15-MAR-2021 09:38  
S:\PROJECTS\17BP.14.R.183\17BP.14.R.183.dgn



6/23/16

**RS&H** NC FIRM LICENSE No: F-0493

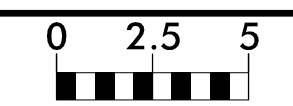

PROJ. REFERENCE NO.  
17BP.14.R.183

SHEET NO.  
X-7

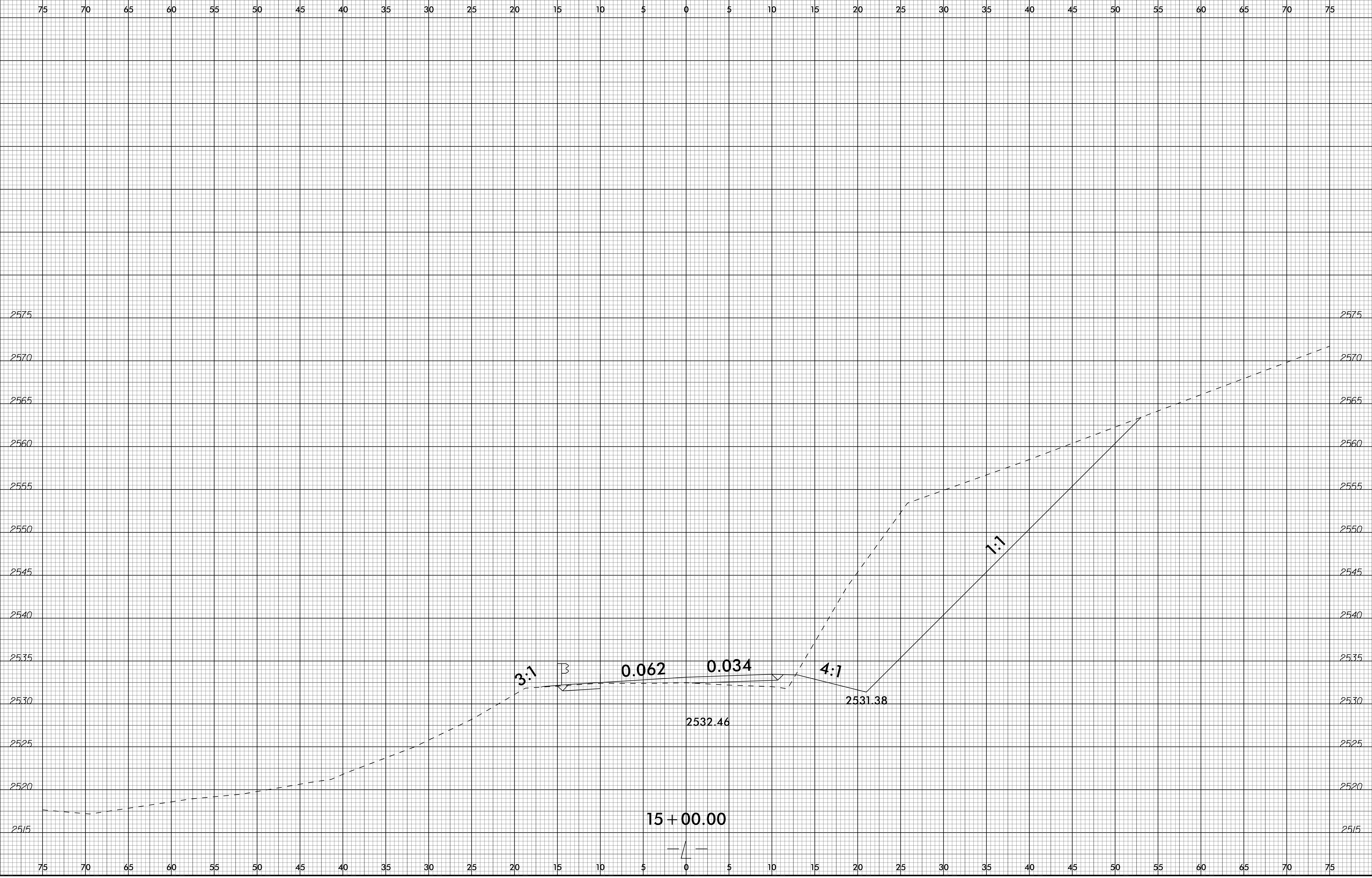

15-MAR-2021 09:39  
S:\PROJECTS\17BP.14.R.183\17BP.14.R.183.dgn

6/23/16

**RS&H** NC FIRM LICENSE No: F-0493

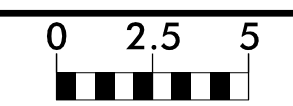

PROJ. REFERENCE NO.  
17BP.14.R.183

SHEET NO.  
X-8

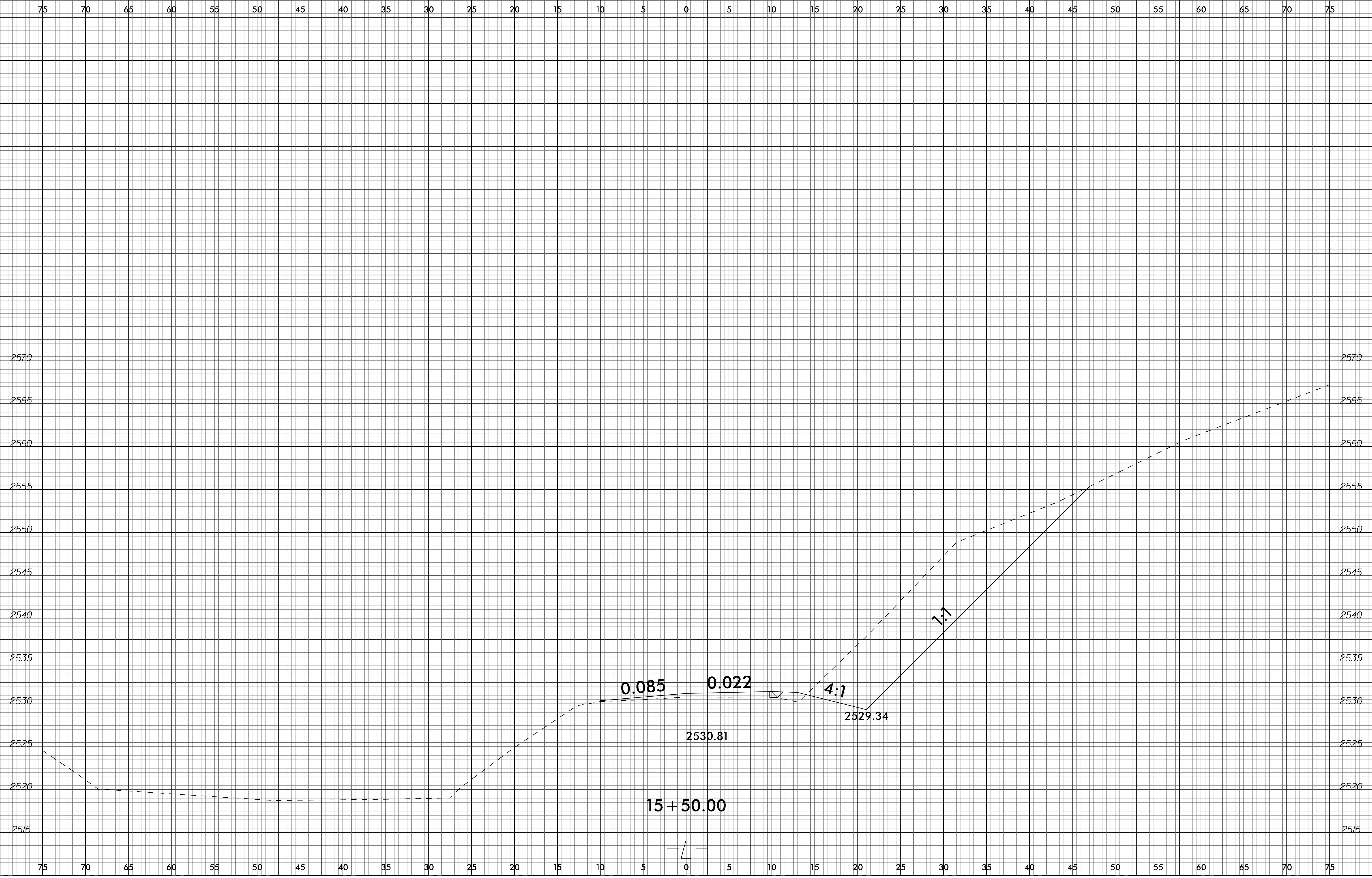

15-MAR-2021 09:39  
S:\PROJECTS\17BP.14.R.183\17BP.14.R.183.dgn

6/23/16

**RS&H** NC FIRM LICENSE No: F-0493

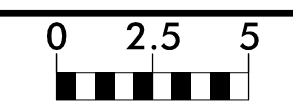

PROJ. REFERENCE NO.  
17BP.14.R.183

SHEET NO.  
X-9

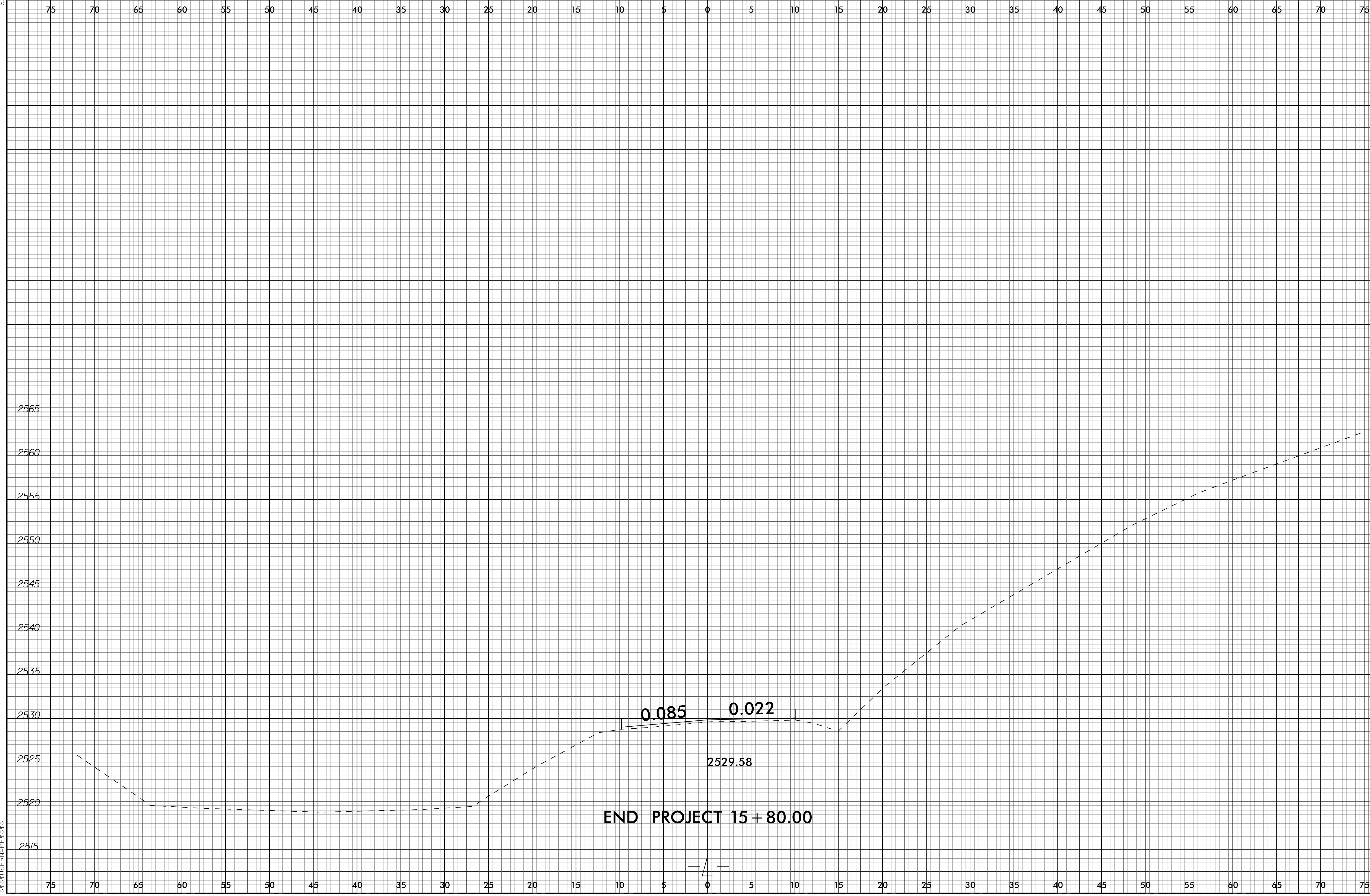

15-MAR-2021 09:40:03 17BP.14.R.183.X-9.dgn  
S:\PROJECTS\17BP.14.R.183\17BP.14.R.183.X-9.dgn

6/23/16

**RS&H** NC FIRM LICENSE No: F-0493

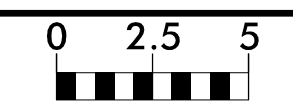

PROJ. REFERENCE NO.	SHEET NO.
17BP.14.R.183	X-10



15-MAR-2021 09:40:08 70063.Rdy\_xpl.L.dgn  
S:\PROJECTS\17BP.14.R.183

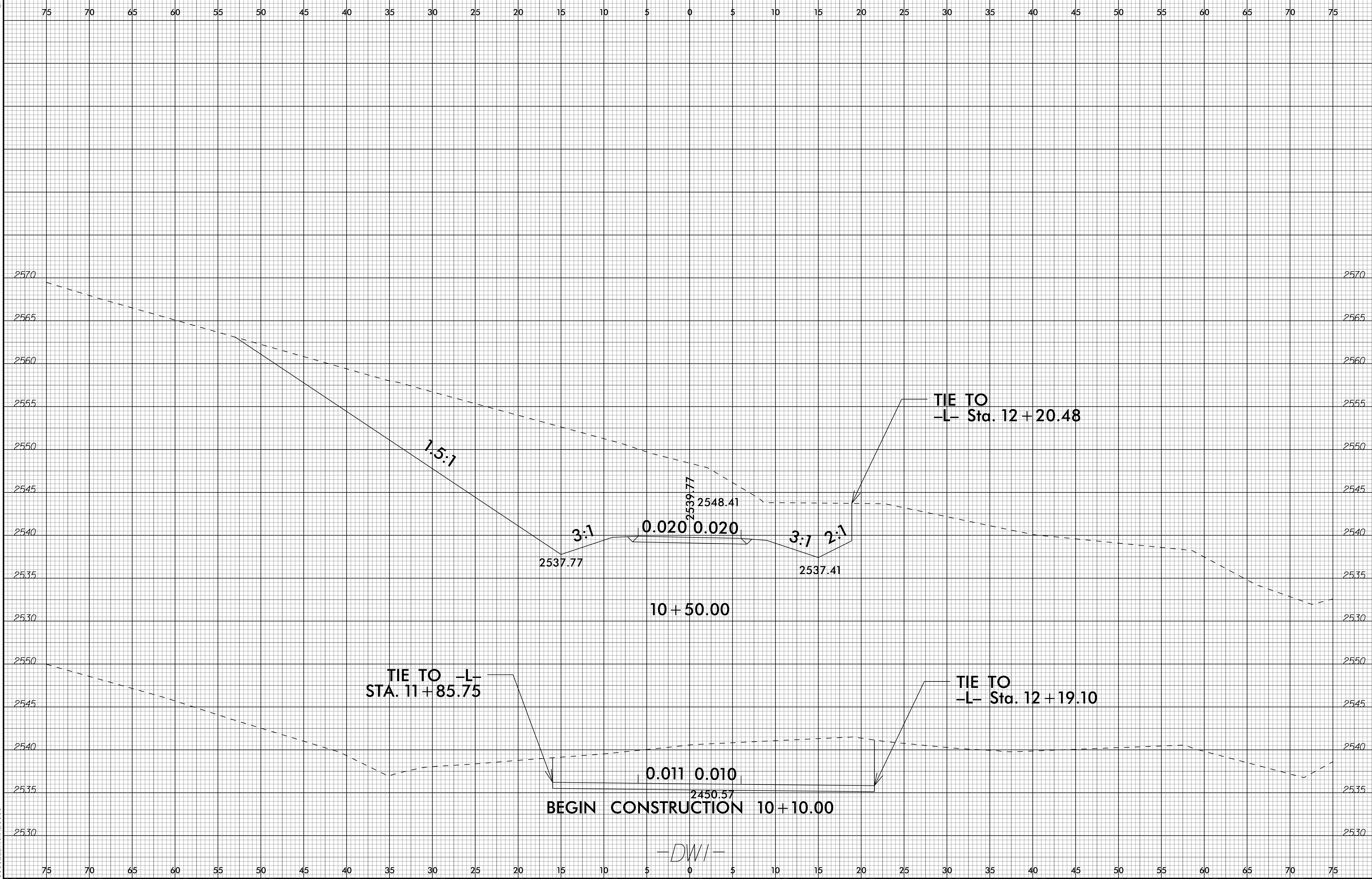

6/23/16

**RS&H** NC FIRM LICENSE No: F-0493

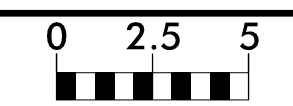

PROJ. REFERENCE NO.	SHEET NO.
17BP.14.R.183	X-12

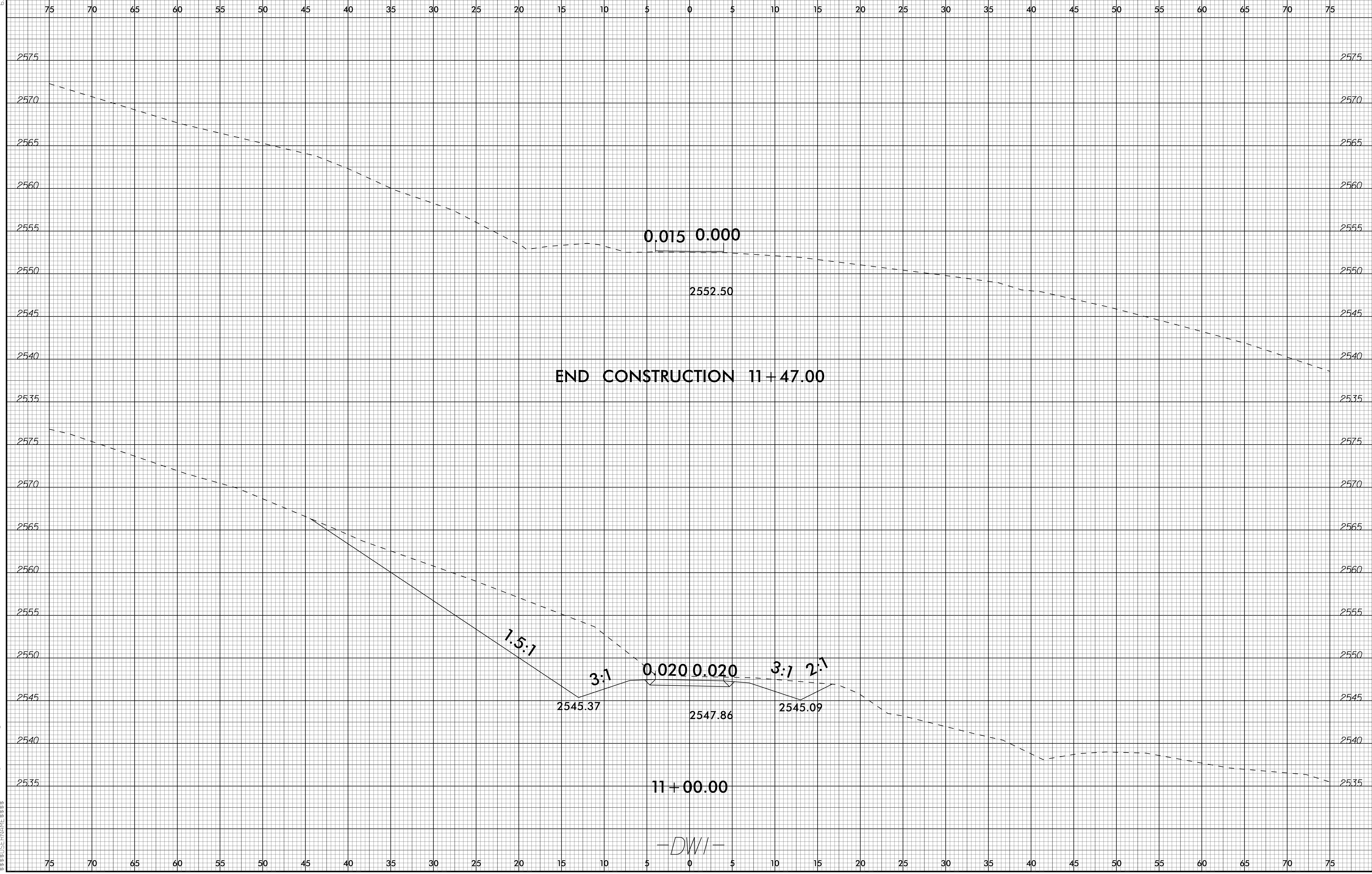

15-MAR-2021 09:32  
S:\PROJECTS\17BP.14.R.183\17BP.14.R.183.dgn

6/23/16

**RS&H** NC FIRM LICENSE No: F-0493

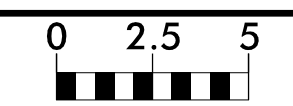

PROJ. REFERENCE NO.	SHEET NO.
17BP.14.R.183	X-13

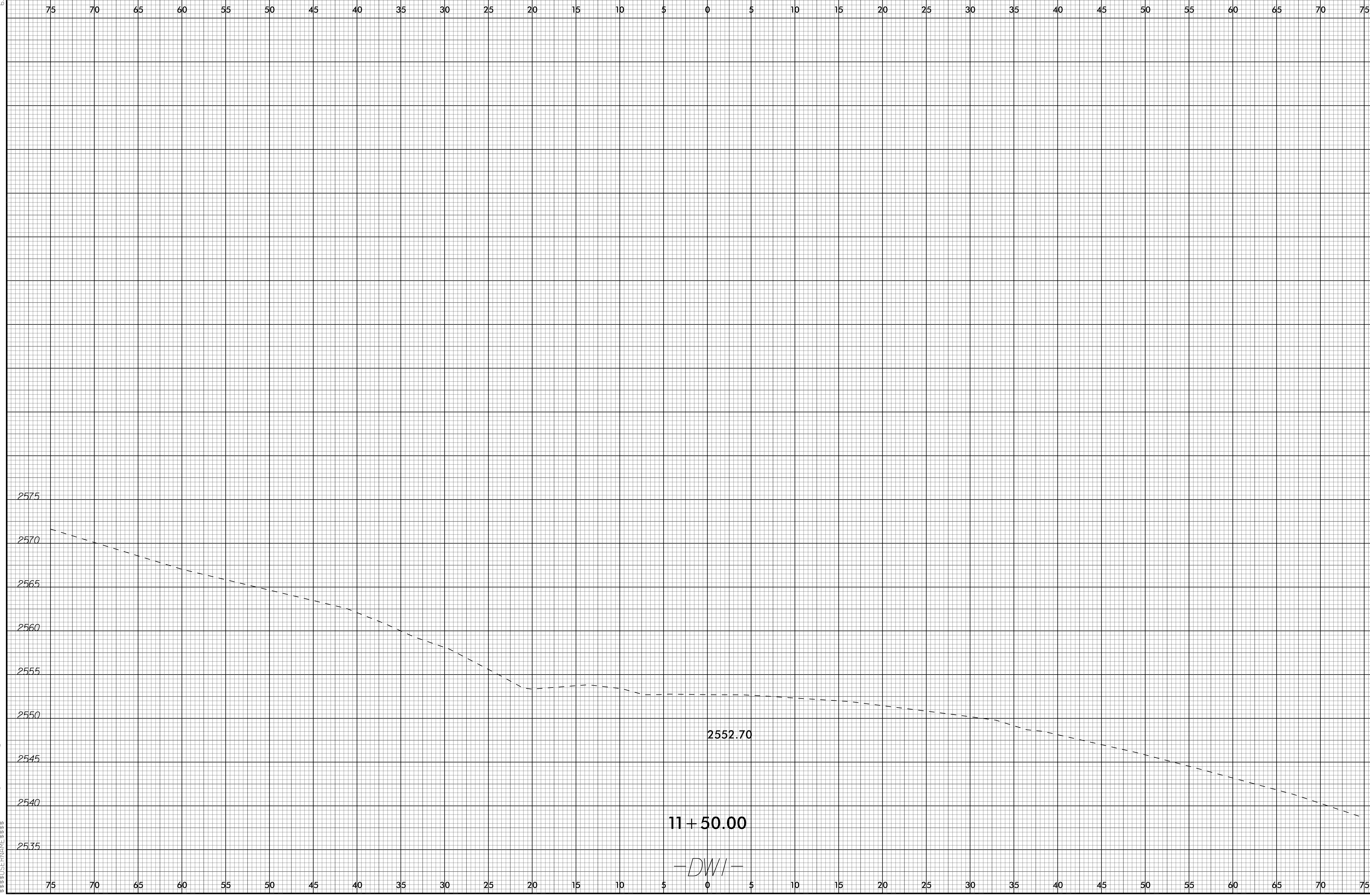

15-MAR-2021 09:32  
S:\PROJECTS\17BP.14.R.183\17BP.14.R.183.dgn

6/23/16

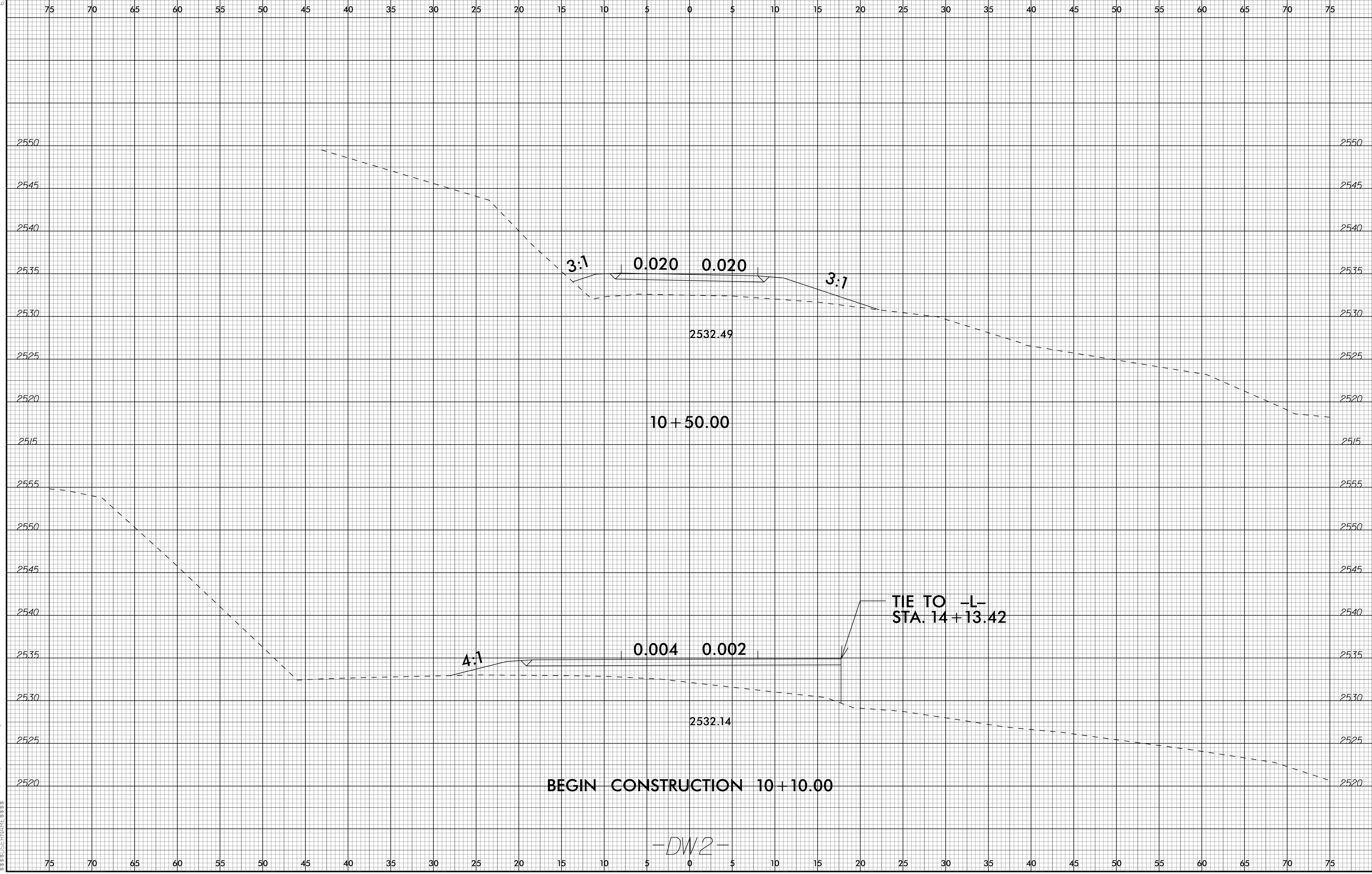
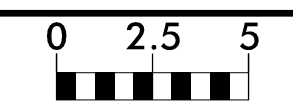

BEGIN CONSTRUCTION 10+10.00

-DW2-

TIE TO -L-  
STA. 14+13.42

10+50.00

2532.49

2532.14

4:1

3:1

3:1

0.020

0.020

0.004

0.002

75 70 65 60 55 50 45 40 35 30 25 20 15 10 5 0 5 10 15 20 25 30 35 40 45 50 55 60 65 70 75

2550  
2545  
2540  
2535  
2530  
2525  
2520  
2515  
2555  
2550  
2545  
2540  
2535  
2530  
2525  
2520

2550  
2545  
2540  
2535  
2530  
2525  
2520  
2515  
2555  
2550  
2545  
2540  
2535  
2530  
2525  
2520

15-MAR-2021 09:34  
S:\PROJECTS\17BP.14.R.183\DWG\DW2.dgn



6/23/16

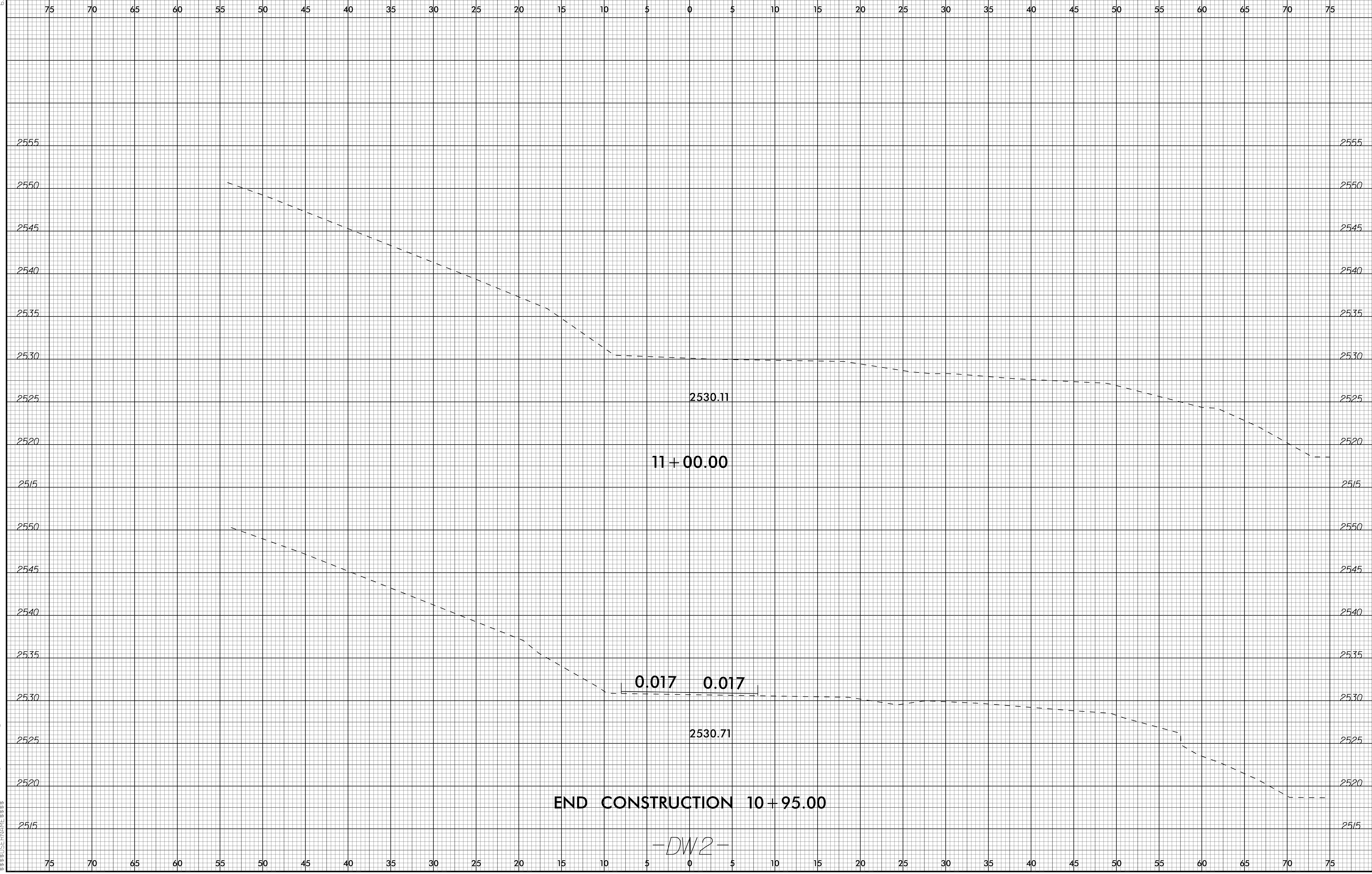
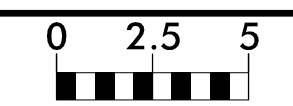

15-MAR-2021 09:35  
S:\PROJECTS\17BP.14.R.183\DWG\DWG2.dgn